

NON-CONTACT ROTARY TORQUE SENSOR

NCRT迴轉式扭力計，係專為旋轉中量測扭力而設計之感測器，採用應變規式轉軸扭力量測結構，剛性強，結構穩固，轉速高。並且具備非接觸式傳遞電源，扭力信號先經放大及數位轉換後，以無線方式將數位扭力信號傳至內部接收板，再以RS-232、RS-485或類比方式輸出。雜訊低、無接觸式電源及信號傳遞。無碳刷及一體式設計、簡潔美觀、堅固耐用。具以下特點：



NCRT sensor is a special design for measuring the torque on a continual rotation shaft. Use the strain gauge shaft to comprise its structure. Equipped a non-contact power supply, and the signal is transferred with internal receiving board after being amplified and translated, and can be transferred by RS-232, RS-485 and $\pm 5V$, $\pm 10V$, 4-20mA output. The characteristic is no carbon brush and integrally formed, beautiful, durable.

■ 特點 Features

- 體積小 Small
- 非接觸式 Non-contact
- NCRT - 0.25, 0.5, 1, 2.5, 5, 10, 25, 50, 100, 250, 500, 1k, 2k, 2.5k, 5k, 10k Nm
- 剛性強 Rigid
- 高轉速 High Speed
- 低雜訊 Low Noise

■ Installation Dimensions

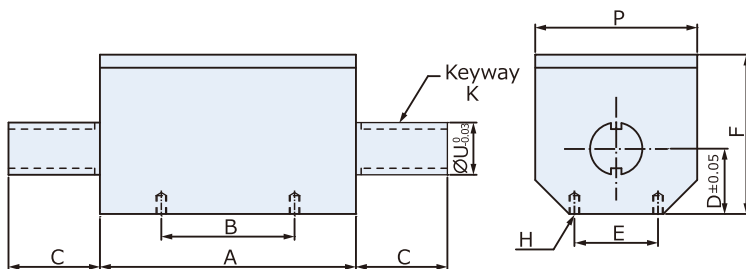

TYPE	A	B	C	D	E	F	H	K	P	U	容許轉速
NCRT-0.25 Nm	96	51	20	18	32	55	M4×0.7 ×7 deep	3×1.8	52	10	12000 RPM
NCRT-0.5 Nm											
NCRT-1 Nm											
NCRT-2.5 Nm											
NCRT-5 Nm											
NCRT-10 Nm											
NCRT-25 Nm	98	51	35	25	32	62	M4×0.7 ×7 deep	4×2.5	62	20	12000 RPM
NCRT-50 Nm											
NCRT-100 Nm											
NCRT-250 Nm											
NCRT-500 Nm	115	65	60	36	44	64	M6×1.0 ×8 deep	10×5	88	40	6000 RPM
NCRT-1 k Nm											
NCRT-2 k Nm											
NCRT-2.5 k Nm	120	65	85	48	50	109	M6×1.0 ×8 deep	12×5	113	55	4500 RPM
NCRT-5 k Nm	131	65	98.5	49	50	110	M6×1.0 ×8 deep	16×6	114	65	4000 RPM
NCRT-10 k Nm	131	75	135	61	60	135	M6×1.0 ×8 deep	25×9	140	90	3000 RPM

■ Specification

總和誤差 Total Error	$\pm 0.3\%R.O.$
重現性 Repeatability	$\pm 0.2\%R.O.$
潛變 Creep	0.1%/20min
解析度 Resolution	10000
最大輸入電壓 Max. Excitation Voltage	24V
建議輸入電壓 Recommended Excitation Voltage	18V
控制接點 Control Contact	780Hz
溫度對零點之影響 Temp. Effect on Zero Balance	Max, Hold, Zero
使用範圍 Safe Temp. Range	$-10^{\circ}C \sim 50^{\circ}C$
溫度對零點之影響 Temp. Effect on Zero Balance	0.05%R.O./ $10^{\circ}C$
溫度對額定輸出之影響 Temp. Effect on Rated Output	0.03%Load/ $10^{\circ}C$
零點誤差 Zero Balance	$\pm 3\%R.O.$
容許負荷 Safe Over Load Rating	150%
導線長度 Cable Length	3m
接線方式 Cable Connection	Input: Red(+)Exci : Black(-)Exci Output: Green(+)Sign White(-)Sign
訂購編號 Ordering Information	NCRT- N - R - O
N- 扭力值 (Nm) Torque Number	
R-RPM output: 0-non, R-output to RPM to meter	
O- 輸出信號格式 Output Signal Format : 485-Modbus RTU, 485-Fast, 232-Fast, $\pm 5V$, $\pm 10V$, 4-20mA	