

# BEAM LOAD CELL

樑式荷重元(B Load cell)係常用的地磅荷重元，其高敏感剪刀感應結構及完全密封式保護，使荷重感應達到最高之精度與敏感度，特別適用於地磅、吊秤、重量、力量量測及自動控制上，具以下之特點：

This is a shear-beam type load cell. Its hermetically sealed and high sensitivity make the load cell be ideal for using in high accuracy truck scales, weight and automatic weighing machines.



## 特點 Features

- 高精度 **High accuracy**
- 溫度補償 **Thermally compensated**
- 密封保護 **Hermetically sealed**
- **B- 10, 20, 35, 50, 100, 200, 750, 500 kg**  
**B- 1, 2, 3, 5, 7.5, 10 t**

## Installation Dimensions

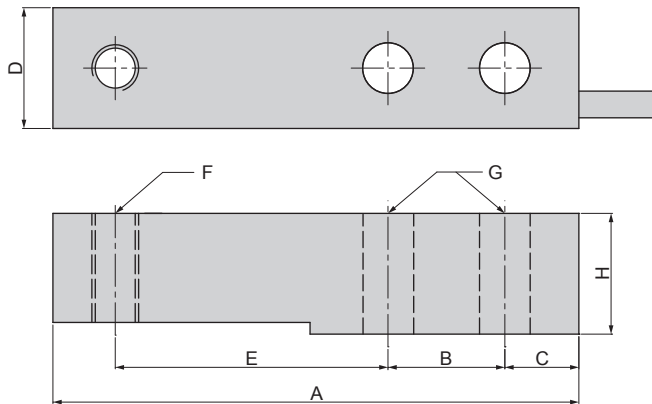

TYPE	A	B	C	D	E	F	G	H
B-10	108	20	14	25	66	M8 × 1.25	φ6.3	28
B-20								
B-35								
B-50								
B-100	135	30	19	31	70	M12 × 1.75	φ13	31
B-200								
B-750								
B-500								
B-1 t	175	38	24	37	95	M16 × 2.0	φ20	37
B-2 t								
B-3 t	190	50	24	48	92	M24 × 3.0	φ26	48
B-5 t								
B-7.5t								
B-10 t								

## Specification

額定輸出 Rated Output	3.0mV/V(B 10~200 2.0mV/V)
總和誤差 Total Error	±0.05%R.O.
重現性 Repeatability	±0.03%R.O.
潛變 Creep	0.05%/20min
輸入阻抗 Input Resistance	430 or 405 ± 25Ω
輸出阻抗 Output Resistance	350 ± 5Ω
最大輸入電壓 Max. Excitation Voltage	20V
建議輸入電壓 Recommended Excitation Voltage	10V
溫度補償範圍 Compensated Temp.Range	-10°C~50°C
使用範圍 Safe Temp. Range	-20°C~70°C
溫度對零點之影響 Temp. Effect on Zero Balance	0.05%R.O./10°C
溫度對額定輸出之影響 Temp. Effect on Rated Output	0.03%Load/10°C
零點誤差 Zero Balance	±3%R.O.
容許負荷 Safe Overload Rating	150%
導線長度 Cable Length	3m
接線方式 Cable Connection	Input:Red(+)Exci : Black(-)Exci Output:Green(+)Sign White(-)Sign